

KUPLEX® II KUPLOK®

Kuplok mechanical coupling links, an essential component of mechanically coupled slings, are used to assemble chain legs to the master link and/or attach eye type fittings.

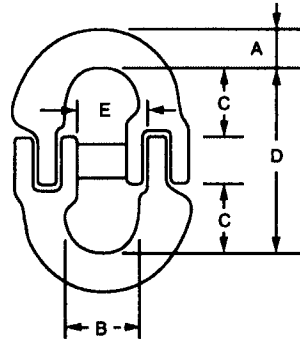

Specifications – Grade 80

Stock Number	Size of Chain		Accoloy Working Load Limits* Lbs.	Max. Width of Link In.	Dia. Hole to Accept Male Leg In.	Wt. Each Lbs.	Qty. Per Box	A	B	C	D	E Largest Mtl. Diam. to be used w/Kuplok
	In.	mm						Dia. Mtl. In.	Inside Width In.	Inside Length In.	Reach In.	
5942-00400	9/32	7	3,500††	1-13/16	35/64	.3	5	3/8	11/16	5/8	1-13/16	1/2
5942-00601	3/8	10	7,100††	2-7/16	47/64	.6	5	1/2	1	15/16	2-3/8	3/4
5942-00801	1/2	13	12,000††	3-11/32	59/64	1.5	5	5/8	1-1/4	1-3/8	3-11/32	1
5942-01001	5/8	16	18,100††	4-3/32	1-1/16	2.4	1	3/4	1-1/2	1-11/16	4	1-1/4
5942-01201	3/4	20	28,300††	4-13/16	1-1/4	3.6	1	15/16	1-3/4	2	4-3/4	1-5/8

††Values shown for these sizes are Grade 80 for larger sizes see Vulcan Forge.

KUPLEX® II KUPLERS

Kuplers act as a connection device between Master Links and Chain on all multiple leg *Kuplex II* Chain Slings. On single leg assemblies they can be used in lieu of the popular *Kuplex II* Kuplink. Resembling a shackle in appearance the Kuplers provide a high strength, high integrity connection when used to connect a special attachment to the alloy chain assembly.

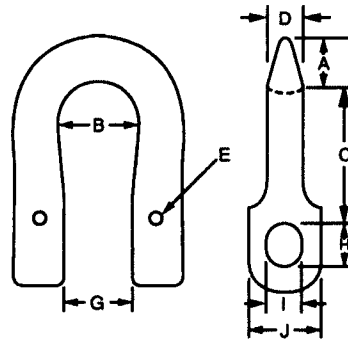

Specifications

Stock Number	Kupler No.	Size of Chain		Accoloy Working Load Limits* Lbs.	A	B	C	D	E	G	H	I	J	Weight Lbs.
		In.	mm		In.	In.	In.	In.	In.	In.	In.	In.		
5981-50020	K-20	9/32	7	4,300†††	7/16	13/16	1-5/16	5/16	1/8	23/32	13/32	11/32	5/8	.3
5981-50021	K-21	3/8	10	8,800†††	19/32	1-1/16	1-13/16	7/16	5/32	7/8	9/16	15/32	7/8	.7
5981-50022	K-22	1/2	13	15,000†††	3/4	1-5/16	2-9/16	9/16	3/16	1-3/32	3/4	21/32	1-1/8	1.5
5981-50023	K-23	5/8	16	22,600†††	15/16	1-5/8	3	11/16	1/4	1-11/32	15/16	13/16	1-1/2	3.0
5981-00024	K-24	3/4	20	28,300††	1	1-15/16	3-13/32	13/16	5/16	1-19/32	1-7/32	1	1-3/4	4.8
5981-00025	K-25	7/8	22	34,200††	1-1/8	2-1/4	3-7/8	15/16	3/8	1-27/32	1-9/32	1-1/16	2	6.1
5991-00026	K-26	1	26	35,900†	1-1/4	2-11/16	4-1/4	1-1/16	NA	2	1-7/32	1-3/32	2-3/8	8.4
5991-00028	K-28	1-1/4	32	56,100†	1-1/2	3-1/2	5-1/8	1-5/16	NA	2-9/32	1-1/2	1-11/32	2-7/8	14.8

†Values shown for these sizes are Grade 63.

††Values shown for these sizes are Grade 80.

†††Values shown for these sizes are Grade 100.

* **WARNING** Working Load Limit must not be exceeded.

KUPLEX® II MASTER KUPLINKS

Most chain slings used today are single branch chain slings. Typical single branch construction are Types CO, SOG, SOS, SOF, etc. Master Kuplinks are the optimum of chain to master link connections. In addition to the streamline characteristics of the Kuplink, there is a definite advantage to field assembly since other coupling devices are unnecessary.

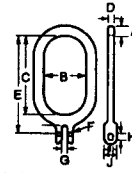

Specifications

Stock Number	Kuplink No.	Size of Chain		Accoloy Working Load Limits* Lbs.	A In.	B In.	C In.	D In.	E In.	F In.	G In.	H In.	I In.	J In.	Weight Lbs.
		In.	mm												
5983-50011	K-11	9/32	7	4,300†††	3/4	3	6	1/2	7-1/8	1/8	5/16	13/32	11/32	5/8	2.5
5983-50012	K-12	3/8	10	8,800†††	3/4	3	6	1/2	7-1/4	5/32	7/16	9/16	15/32	7/8	2.7
5983-50013	K-13	1/2	13	15,000†††	15/16	3	6	11/16	7-9/16	3/16	9/16	3/4	21/32	1-1/8	4.4
5983-50014	K-14	5/8	16	22,600†††	1-1/8	4	8	7/8	9-15/16	1/4	11/16	15/16	13/16	1-1/2	8.2
5983-00015	K-15	3/4	20	28,300††	1-1/4	4	8	7/8	10-3/16	5/16	13/16	1-7/32	1	1-3/4	11.6

††Values shown for these sizes are Grade 80.

†††Values shown for these sizes are Grade 100.

KUPLEX® II LOAD PINS & SPIROL®† PINS

All Kuplex II components derive their high integrity connection from the special Kuplex II Load Pins and Spirol Pins.

The load pins are made from alloy steel heat treated to obtain optimum rated performance properties. The load pins are specially shaped to develop strength characteristics and resistance to bending under rated load. The oval shape presents a greater force area than conventional round pins.

Important: Use only genuine Kuplex load and retaining pins when assembling slings. Never use rods, bolts or other objects of questionable strength and metallurgy. Failure could cause serious injury or damage to property.

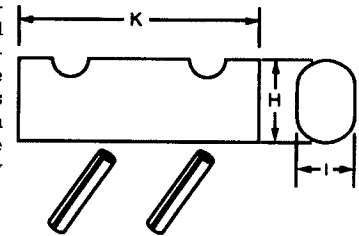

Specifications

Size of Chain In.	Hooks, Kuplinks & Choke Hook Links				Kuplers			Spirol Retaining Pin	
	H In.	I In.	K In.	Stock No. Load Pin Set*	K In.	Stock No. Load Pin Set†	Stock No.	Qty. Per Ctn.	
9/32	13/32	5/16	1-5/32	5989-50232†††	1-17/32	5989-50132†††	5989-00332	100	
3/8	9/16	15/32	1-21/32	5989-50233†††	2-3/32	5989-50133†††	5989-00333	50	
1/2	23/32	5/8	2-7/32	5989-50234†††	2-23/32	5989-50134†††	5989-00334	50	
5/8	59/64	25/32	2-9/16	5989-50235†††	3-7/32	5989-50135†††	5989-00335	25	
3/4	1-3/16	1	3-1/8	5989-00236††	3-15/16	5989-00136††	5989-00336	10	
7/8	1-1/4	1-1/16	3-9/16	5989-00237††	4-17/32	5989-00137††	5989-00337	Bulk	

††Values shown for these sizes are Grade 80.

†††Values shown for these sizes are Grade 100.

All dimensions are shown in inches.

•One Load Pin and two Spirol Pins are bagged. There is an occasional need for replacement of Spirol and Load Pins. The same load pins cannot be used in both Kuplers and Hooks. When ordering these parts separately, be sure to specify whether they are for Kuplers or Hooks and also specify Kupler Number or the Hook Number with which they are to be used.

ACCOLOY® KUPLEX® II LATCH ASSEMBLY FOR USE W/BOTH ACCOLOY EYE TYPE & KUPLEX II CLEVIS TYPE SLING HOOKS

Specifications

Stock No. Latch Assy. Only	To be used with Hook Number	E In.	Size of Chain	
			In.	mm
5999-00402	K-80	1	9/32	7
5999-00403	K-81	1-3/8	3/8	10
5999-00404	K-82	1-5/8	1/2	13
5999-00405	K-83	2-1/8	5/8	16
5999-00406	K-84	2-7/16	3/4	20
5999-00407	K-85	2-5/8	7/8	22
5999-00408	K-86	3-1/4	1	26
5999-00410	K-88	3-3/4	1-1/4	32

As you will note we have given you the "E Dimension" (throat opening) with the latch completely depressed; the balance of sling hook dimension remains the same.

